

SJP – PJPII School 5k
 Southern Pines, NC

SJP –PJPII School 5k Split Locations

No splits shown to provide flexibility with direction of route.

Measured:

by Brad Smythe
 bdsmythe78@yahoo.com
 on August 2, 2014

SJP –PJPII School 5k Course Directions

Start at south edge of middle road through School, see detail
 Run south along right edge of baseball field, keeping woods to right
 Run between volleyball course to left and pond to right
 Right turn on middle school road
 Left on Entrance Road
 Follow Entrance Road to back parking lot aisle
 Right onto dirt road
 Right at woods line behind Cemetery
 Left over berm at break in woods to golf practice area
 Right to circle along woods around golf practice area
 Straight across open field to break between pond on right and tennis ct on left
 Left on Waters Drive
 Right on Sidewalk to putting green
 Counter clockwise around putting green to gravel wellness trail
 Wellness trail along Waters Drive to parking lot
 Straight across parking lot to left at driveway
 Left on Waters Drive
 Right on gravel road at garden
 Straight to sidewalk
 Follow sidewalk counter clockwise around lake to access road
 Left on access road to left after medical center
 Straight at end of parking lot onto gravel road
 Left on Waters Drive past garden
 Right past tennis court through field
 Straight through field across berm and back to dirt road
 Follow dirt road to the left at end of cemetery
 Right on paved road to finish at end of parking aisle.

*Runners have use of full width of roads and sidewalks.
 Race Director to set up a 10' wide running course, with one side on edge of woods or other defined area where course is not on road or sidewalk.*

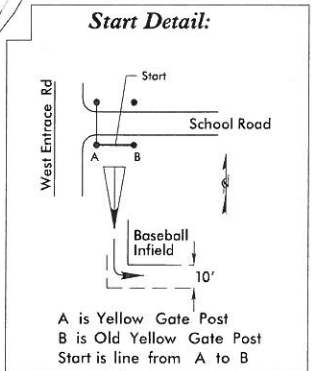
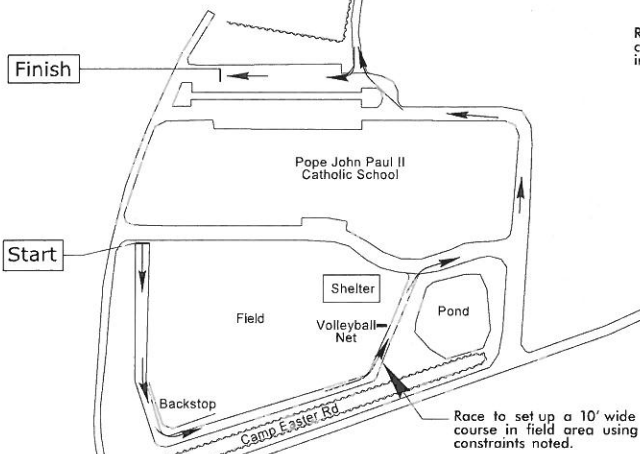
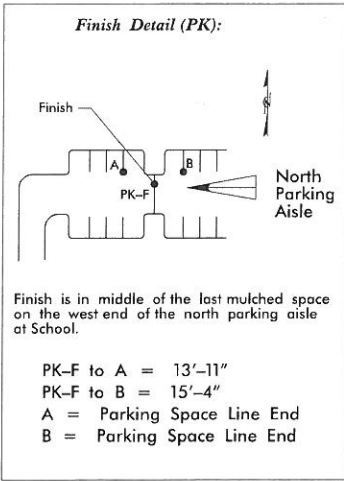
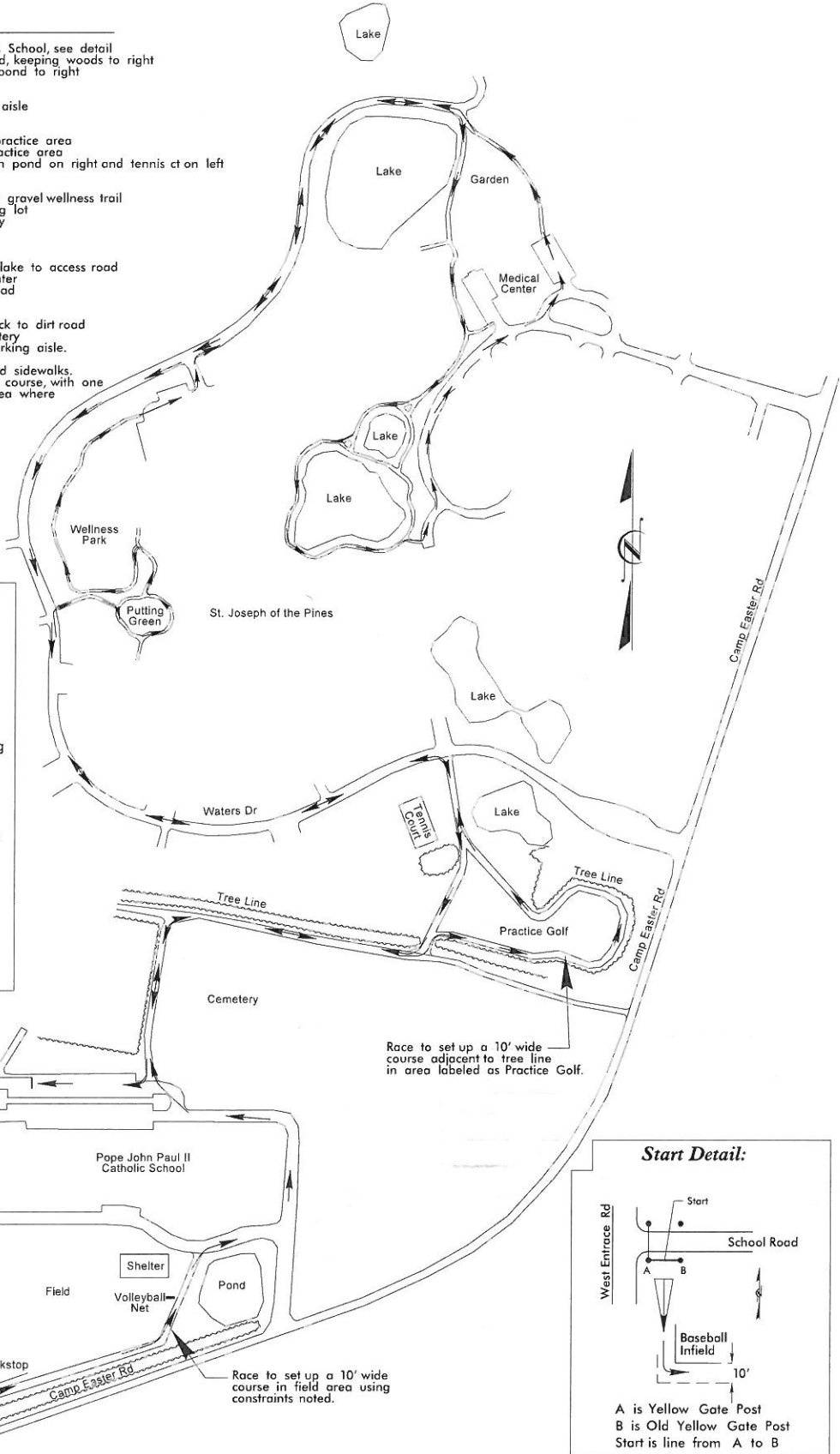

Note:
 Map not to scale
 Not all streets are shown.